

H:\ProjectFiles\2022\2335-00-2400 Building Remodel and TIDRAWINGS\CAD\S2.40 - PLOTTED - 2023-10-05 1:33:19 PM

REVISED
4:04 pm, Oct 06, 2023

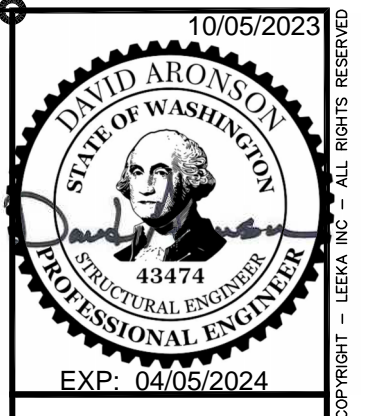

LEEKA Architecture and Planning
Creating Positive Impressions in the Built Environment
1001 SE Water Avenue, Suite 175
Portland, Oregon 97214
503.644.4222
lee@leeka.com
www.leeka.com

Tenant Improvement
ESD112
Mental Health Facility Phase II
2400 NE 65th Ave., Vancouver WA.

Revised: DELTA 4 - APPLICANT EDITS

Job No: 2246
Date: Oct. 03, 2023
File Size: 24x36
Progress set
DRAWN: NYL
CHECKED: NYL
Sheet Title
FOUNDATION PLAN

Sheet Number
S2.40

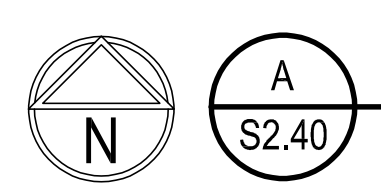
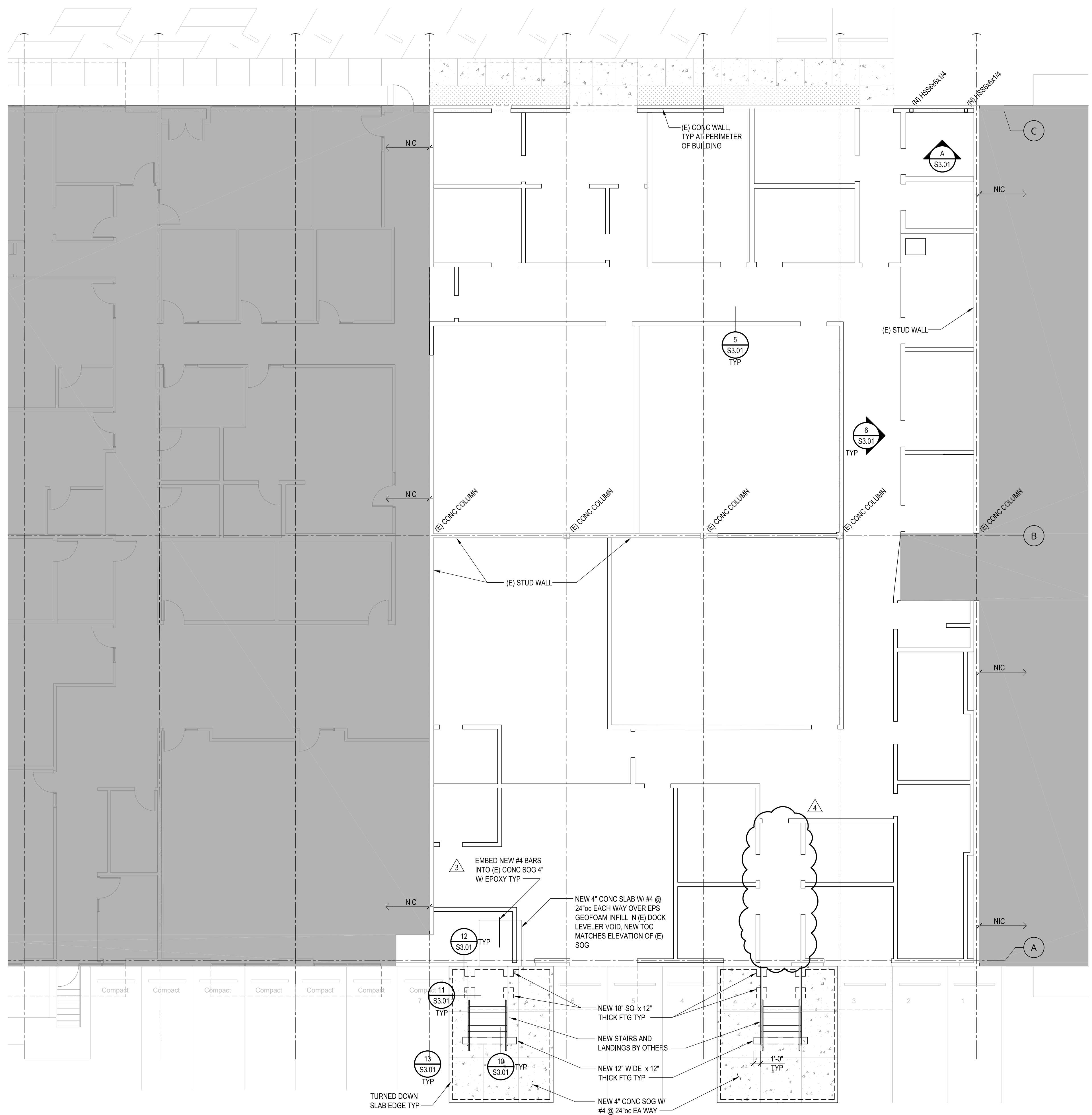

PARTIAL FOUNDATION PLAN

1/8" = 1'-0"

- NOTES**
1. ALL INTERIOR STUD WALLS TO BE 2x6 DF-L No2 @ 24"oc