

REVISED
9:21 am, Jan 22, 2024

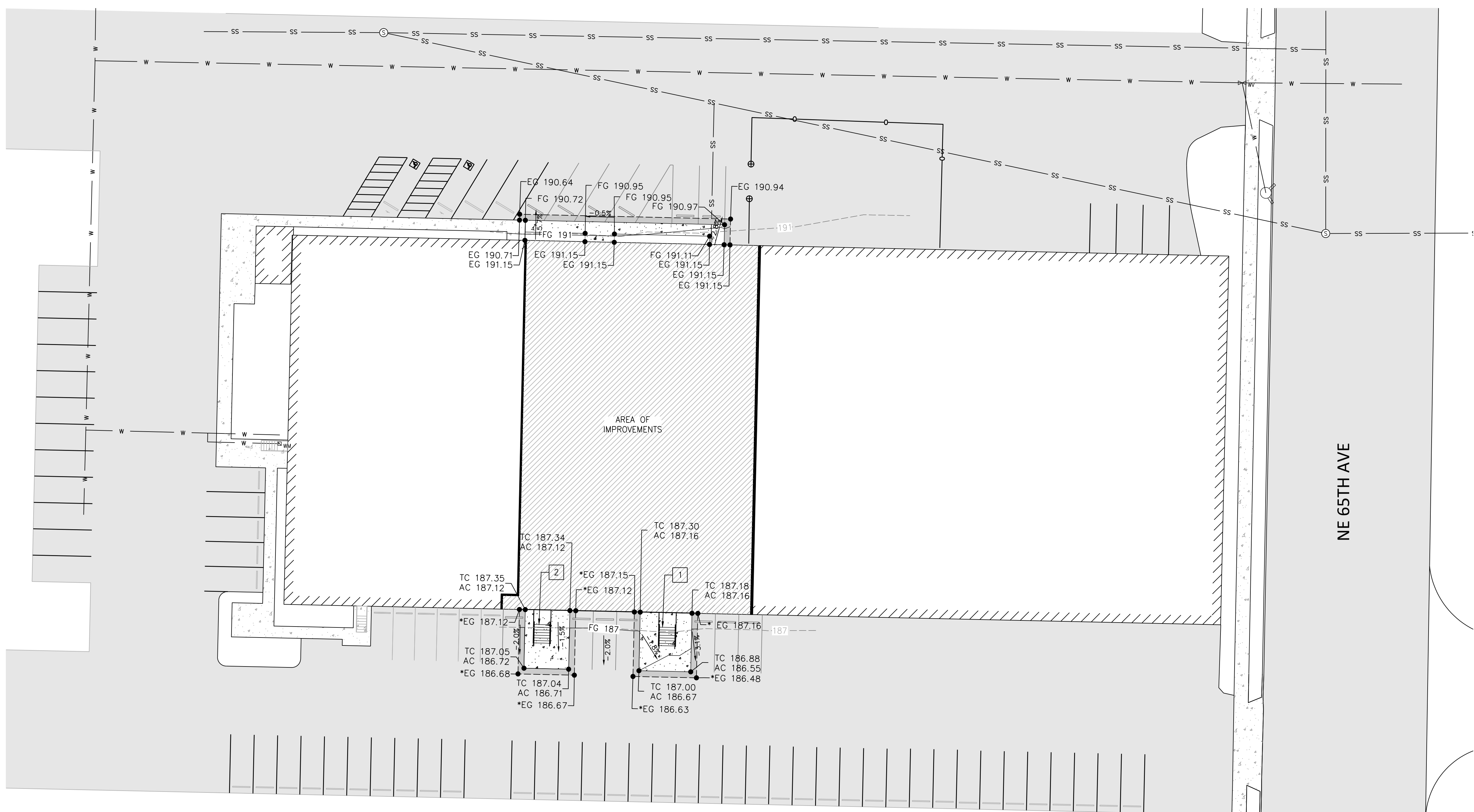
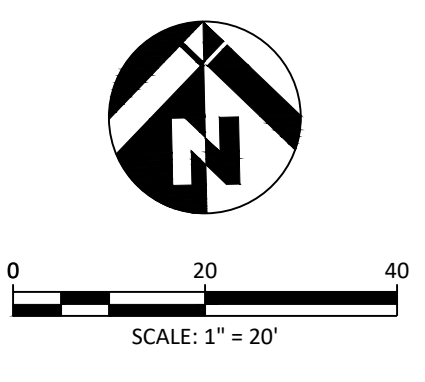

GRADING NOTES:

CONCRETE PAD TO BE INSTALLED AT 1.5% SLOPE AWAY FROM BUILDING. EXPOSURE ON SOUTH END IS 0.33' (PROVIDE 4" EXPOSURE AFTER MATCHING ASPHALT ELEVATION). EXPOSURE AT BUILDING IS DEPENDENT ON EXISTING SLOPE.

*SPOT ELEVATIONS THAT HAVE BEEN INTERPOLATED USING AVAILABLE SURVEY DATA. ACTUAL ELEVATIONS IN FIELD MAY BE DIFFERENT BUT WILL HAVE NEGLIGIBLE EFFECT ON THE DESIGN.

GRADING CONSTRUCTION NOTES:

- 1 ELEVATION AT THE TOP OF EASTERN STAIRS IS ~191.04 AND ELEVATION AT THE BOTTOM OF THE STAIRS IS ~187.05 (STAIR HEIGHT OF ~3.99').
- 2 ELEVATION AT THE TOP OF WESTERN STAIRS IS ~191.04 AND ELEVATION AT THE BOTTOM OF THE STAIRS IS ~187.16 (STAIR HEIGHT OF ~3.88').

FILE: W:\18009 ESD BLDG 2400\500 DESIGN\502 DRAWINGS\SHEETS\C200 GRADING PLAN.DWG



5/1/2023

**ESD BUILDING 2400
VANCOUVER, WASHINGTON
GRADING PLAN**

REVISIONS:

JOB NO.:	18009
DATE:	4/19/2023
SCALE:	1" = 20'
DESIGNED BY:	PM
DRAWN BY:	PM
CHECKED BY:	DW

PERMIT SET