

REVISED  
9:23 am, Jan 22, 2024

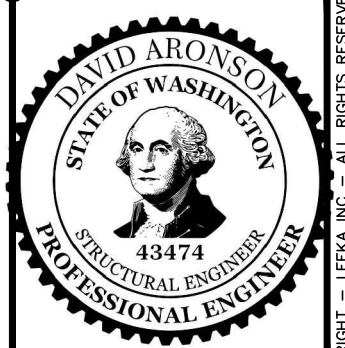

**LEEKA** Architecture and Planning  
Creating Positive Impressions in the Built Environment  
1001 SE Water Avenue, Suite 175  
Portland, Oregon 97214  
503.644.4222  
lee@leeka.com  
www.leeka.com

Tenant Improvement  
ESD112  
Mental Health Facility Phase II  
2400 NE 65th Ave. Vancouver WA.

Revised: JAN 3, 2024  
APPLICANT EDITS

Job No: 2246  
Date: JAN 3, 2024  
File Size: 24x36  
Progress set  
DRAWN: --  
CHECKED: --

Sheet Title  
FOUNDATION PLAN  
Sheet Number  
**S2.40**

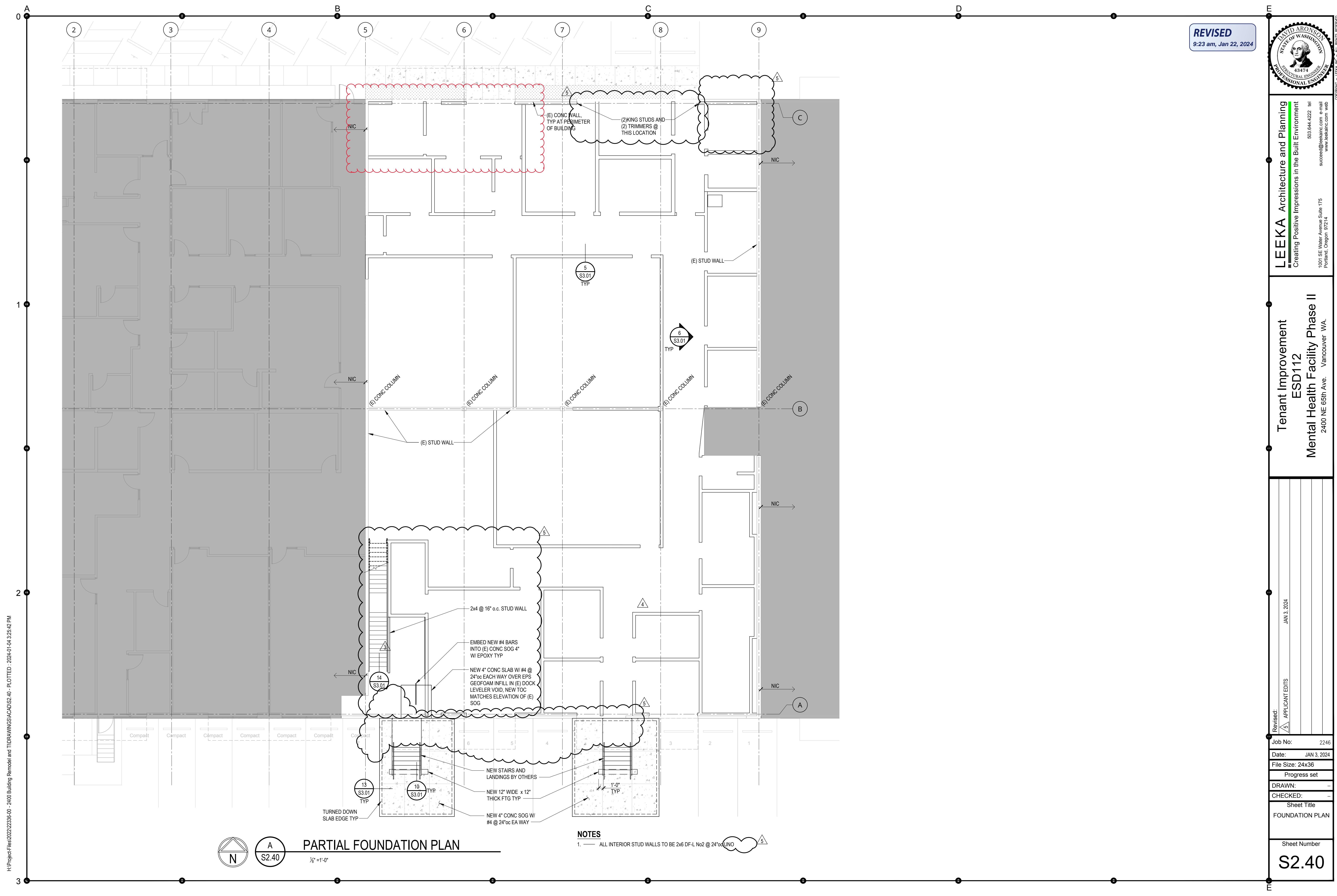

**A**  
S2.40  
PARTIAL FOUNDATION PLAN  
1/8" = 1'-0"

**NOTES**  
1. ALL INTERIOR STUD WALLS TO BE 2x6 DF-L No2 @ 24" o.c. UNO

HiProjectFiles\2022\2335-00 - 2400 Building Remodel and TI\DRAWINGS\CADD\S2.40 - PLOTTED - 2024-01-04 3:25:42 PM